



AMERICLAD® AC-95SCV  
www.americlad.com  
866-260-4047

MANUFACTURER:  
Quality Metalcrafts, LLC  
21925 Industrial Blvd.  
Rogers, MN 55374  
Telephone: (866) 260-4047  
Fax: (763) 255-3399  
Email: [info@americlad.com](mailto:info@americlad.com)

**AMERICLAD  
AC-95SCV  
Louver**

**SECTION 08 90 00  
VERTICAL ALUMINUM LOUVER SYSTEM  
5" STATIONARY WIND DRIVEN RAIN RESISTANT  
LOUVER WITH CHANNEL FRAME**

**PART 1 – GENERAL**

**1.1 RELATED DOCUMENTS**

- A. The drawings and provisions of the General Conditions, and the sections included under Division 1 specification sections, apply to this section

**1.2 SUMMARY**

- A. This section includes aluminum louvers

**1.3 PERFORMANCE REQUIREMENTS**

- A. Performance Ratings: Product must be licensed to bear the AMCA Certified Ratings Seal for water and air performance
  - a. Based on testing 48 inches by 48 inches (1,219 mm x 1,219 mm) size unit in accordance with AMCA 500
- B. Free area: 8.34 square feet, 43%
- C. Water Penetration: Maximum 0.01 ounces per square foot of free area at an air flow of 1250 feet per minute free area velocity when tested

**1.4 SUBMITTALS**

- A. Product Data: Manufacturer's product literature
- B. Finish Samples: submit color samples for final approval



- C. Shop Drawings: submit shop drawings showing plans, sections and details

### **1.5 QUALITY ASSURANCE**

- A. Manufacturer Qualifications: Minimum of five years experience in manufacturing of architectural products
- B. Installer Qualifications: Acceptable to manufacturer
- C. Production Qualifications: Louvers shall be licensed to bear AMCA Certified Ratings Seal Applies to air performance and water penetration ratings

### **1.6 DELIVERY, STORAGE AND HANDLING**

- A. Delivery: deliver louvers in manufacturer's crates packed for long haul transit
- B. Storage: store materials in a dry and safe area
- C. Handling: handle materials to avoid any damage to materials and finishes

### **1.7 WARRANTY**

- A. The contractor must warrant the materials to be free of defects in accordance with the general conditions. Finish warranty shall be extended by paint manufacturer's standard warranty
- B. Manufacturer shall provide a standard limited warranty for louver system for a period of one year from date of installation and no more than eighteen months after shipment from manufacturing plant

## **PART 2 – PRODUCTS**

### **2.1 MANUFACTURER**

- A. Quality Metalcrafts, LLC/AMERICLAD, 21925 Industrial Boulevard, Rogers, Minnesota 55374, Telephone: (866) 260-4047, [www.americlad.com](http://www.americlad.com)
- A. Approved equal submitted for approval 10 days prior to bid

### **2.2 FABRICATION**

- A. Model: AC-95SCV Aluminum Louver System, 5" stationary, wind driven rain resistant louver with channel frame
- B. Performance Ratings: AMCA Licensed
- C. Frame:
  - a. Depth: 5" (152.4 mm)
  - b. Material: Extruded aluminum 6063-T5
  - c. Wall Thickness: 0.081 inch (2.06 mm), nominal



- d. Downspouts and caulking surfaces
- D. Blades:
  - a. Style: Stationary Wind Driven Rain Resistant
  - b. Material: Extruded aluminum 6063-T5
  - c. Wall Thickness: 0.081 inch (2.06 mm), nominal
  - d. Angle: Double Drainable, Sight Proof Blades
  - e. Centers 2.125 inches (53.98 mm), nominal

### 2.3 ACCESSORIES

- A. Aluminum Sill: Provide sill flashing manufactured from same material and finish as louvers where indicated on drawings
- B. Screens: provide framed removable screens for exterior louvers
  - a. Bird Screens
  - b. Insect Screens
  - c. Blank off Panels
    - i. Insulated
    - ii. Non-insulated

### 2.4 FINISHES

- A. Paint:
  - 1. Coating shall be a Spray Applied Fluorocarbon Resin Utilizing a 70% Kynar 500/Hylar 5000 resin
  - 2. Color as selected by owner from paint manufacturer's standard colors or Custom color as specified
  - 3. Material to be painted in accordance with either AAMA specification 2605 or 2604
- B. Anodized:
  - 1. Class I, Clear Anodic Finish: AA-M12C22A41, mechanical finish, nonspecular as fabricated. Coating to have an anodic coating of 0.7 mil (0.018 mm) thickness
  - 2. Class I, Color Anodic Finish: AA-M12C22A42/A44, mechanical finish, nonspecular as fabricated. Color to be determined by Owner. Coating to have an anodic coating of 0.7 mil (0.018) thickness

## PART 3 – EXECUTION

### 3.1 PREPARATION

- A. Coordinate drawings, diagrams, and instructions for installation

### 3.2 INSTALLATION



AMERICLAD® AC-95SCV  
www.americlad.com  
866-260-4047

- A. Install louvers at locations as indicated on the drawings and in accordance with the manufacturer's instructions
- B. Install louvers plumb, level, in plane of wall, and in alignment with adjacent work
- C. Install joint sealants as specified in section 07 90 00

### **3.3 CLEANING AND PROTECTION**

- A. Clean exposed surfaces after installation per manufacturer's recommendation
- B. Touch up minor abrasions in finish with touch up paint supplied by finish applicator

**END OF SECTION**



21925 Industrial Blvd.  
 Rogers, MN 55374  
 866-260-4047  
 www.americlad.com

**AC-95SCV STATIONARY WIND DRIVEN RAIN RESISTANT LOUVER**  
 CHANNEL FRAME

**STANDARD CONSTRUCTION**

**FRAME**

- 5" deep, 6063-T5 extruded aluminum with a .081" nominal wall thickness

**BLADES**

- 6063-T5 extruded aluminum with a .081" nominal wall thickness
- Double drainable, sight-proof blades spaced on approximately 2" centers

**SCREEN**

- 0.75" x .051" thick, aluminum flattened expanded metal bird screen in a removable frame
- Screen will add approximately 0.5" to the overall louver depth

**FINISH**

- Mill Finish

**MINIMUM LOUVER SIZE**

- 12" wide x 12" high

**MAXIMUM LOUVER SIZE**

- 70 square feet per section
- Single section size not to exceed 120" wide x 84" high or 84" wide x 120" high
- Louvers exceeding the maximum single section size will be built in multiple sections and require field assembly

**BLADE BRACE SUPPORT ANGLES**

- Depending on louver size, wind load, or other special requirements, louvers will have rear mounted blade support angles that will increase overall louver depth

**Note: Louvers built .25" smaller than**

**STANDARD FEATURES**

- Aluminum construction, providing a high resistance to corrosion
- 46% Free Area (based on a 48" x 48" unit)
- Tested in accordance with AMCA 500-L Laboratory Methods of testing Wind-Driven Rain Performance
- Published performance ratings data based on testing in accordance with AMCA Publication 511

**OPTIONS AVAILABLE**

Many optional accessories to the basic design are available at an additional cost, including:

- Sill extension/head flashing
- Hinged frame/channel subframe
- Security bars
- Filter rack
- Bird/insect screens (please refer to screen submittal)
- Blank-off panels (standard or insulated)

**FINISHES**

- Kynar 500/Hylar 5000
- Baked Enamel
- Prime Coat
- Anodized in various colors and shades (some color variation is possible with anodized finishes)

**Contact Quality Metalcrafts, LLC / AMERICLAD® for any additional information or any special requirements**

**AC-95SCV PERFORMANCE DATA SHEET**

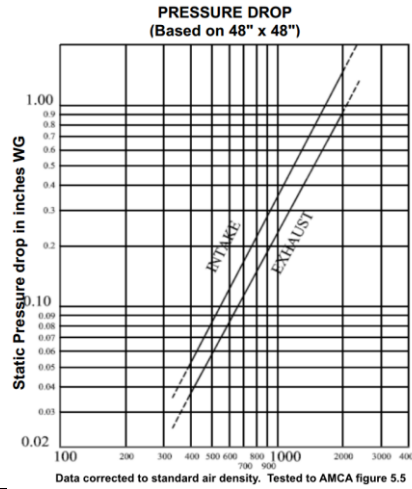

Quality Metalcrafts, LLC certifies that the louver shown herein is licensed to bear the AMCA seal. Ratings shown are based on tests and procedures performed in accordance with AMCA Publication 511 and comply with the requirements of the AMCA Certified Ratings Program. The AMCA Certified Ratings seal applies to air performance and wind-driven rain ratings only.

**WIND-DRIVEN RAIN PERFORMANCE**

Test size is 39.375" x 39.375" Core Area

Wind Velocity (mph)	Rain Fall Rate (in./hr.)	Core Velocity fpm	Airflow cfm	Free Area Velocity fpm	Effectiveness Ratio	Class
29	3	779	8389	1691	100	A
29	3	865	9310	1877	99.9	A
29	3	993	10692	2156	98.2	B
50	8	568	6113	1232	99.3	A
50	8	776	8351	1684	95.9	B

Discharge Loss Coefficient Classifications	
Class	Discharge Loss Coefficient
1	0.4 and Above
2	0.3 to 0.399
3	0.2 to 0.299
4	0.199 and Below

Wind-Driven Rain Penetration Classes	
Class	Effectiveness
A	1 to 0.99
B	0.989 to 0.95
C	0.949 to 0.80
D	Below 0.80

**AC-95SC FREE AREA CHART**

Free area chart shows square feet of free area of various louver sizes

Free Area AMCA Licensed for openings up to 84" x 120"

H/W	12	24	36	48	60	72	84	96	108	120
12	0.17	0.43	0.69	0.95	1.21	1.46	1.72	1.98	2.24	2.50
24	0.53	1.33	2.13	2.92	3.72	4.52	5.32	6.11	6.91	7.71
36	0.89	2.23	3.56	4.90	6.24	7.57	8.91	10.24	11.58	12.92
48	1.25	3.13	5.00	6.88	8.75	10.63	12.50	14.38	16.25	18.13
60	1.61	4.02	6.44	8.85	11.27	13.68	16.10	18.51	20.92	23.34
72	1.97	4.92	7.88	10.83	13.78	16.74	19.69	22.64	25.60	28.55
84	2.33	5.82	9.31	12.80	16.30	19.79	23.28	26.77	30.27	33.76
96	2.69	6.72	10.75	14.78	18.81	22.84	26.88	30.91	34.94	38.97
108	3.05	7.62	12.19	16.76	21.33	25.90	30.47	35.04	39.61	44.18
120	3.41	8.52	13.62	18.73	23.84	28.95	34.06	39.17	44.28	49.39



AC-95SCV

LOUVER - 5 INCH VERTICAL WIND DRIVEN W/ CHANNEL

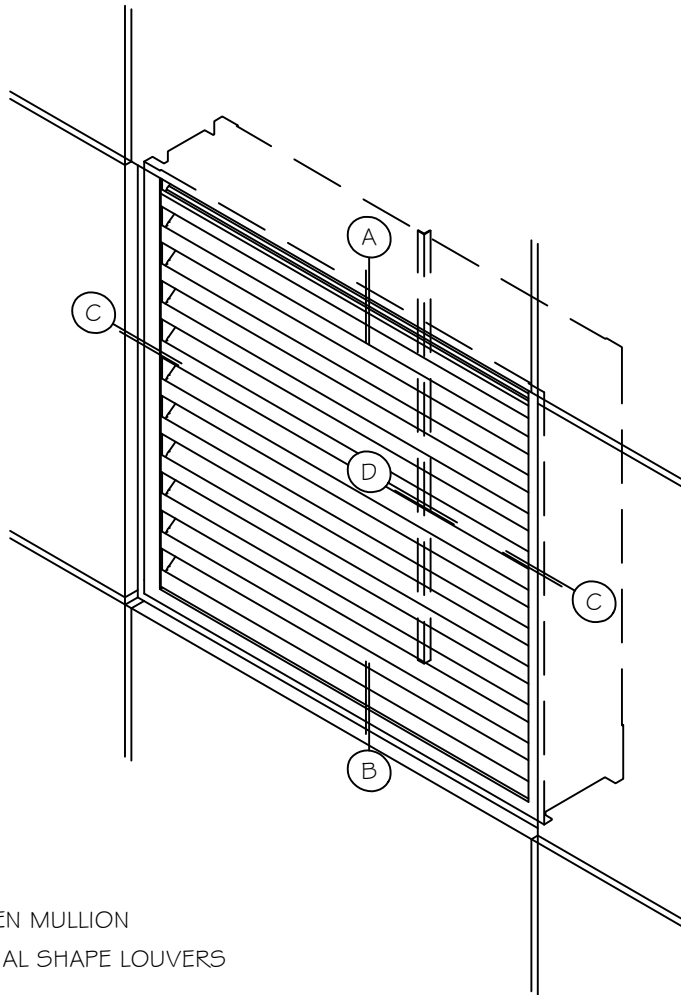

- (A) HEAD
- (B) SILL
- (C) JAMB
- (D) HIDDEN MULLION
- (E) SPECIAL SHAPE LOUVERS

COPYRIGHT QUALITY METALCRAFTS, LLC

21925 Industrial Boulevard · Rogers, Minnesota · Toll-Free: 1-866-260-4047 · [americlad.com](http://americlad.com)  
Architectural Metal Products



AC-95SCV

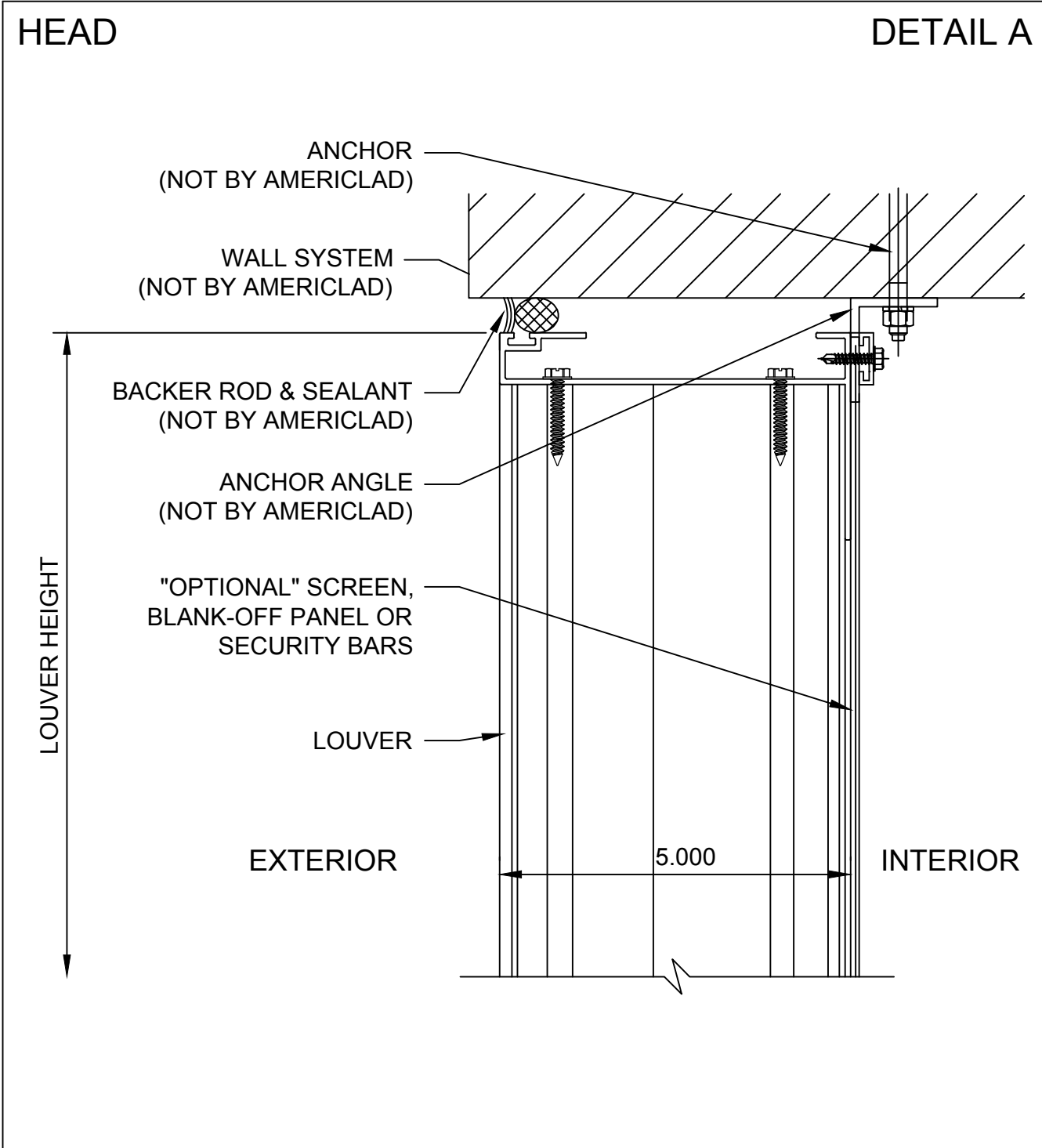

COPYRIGHT QUALITY METALCRAFTS, LLC





AC-95SCV

SILL

DETAIL B

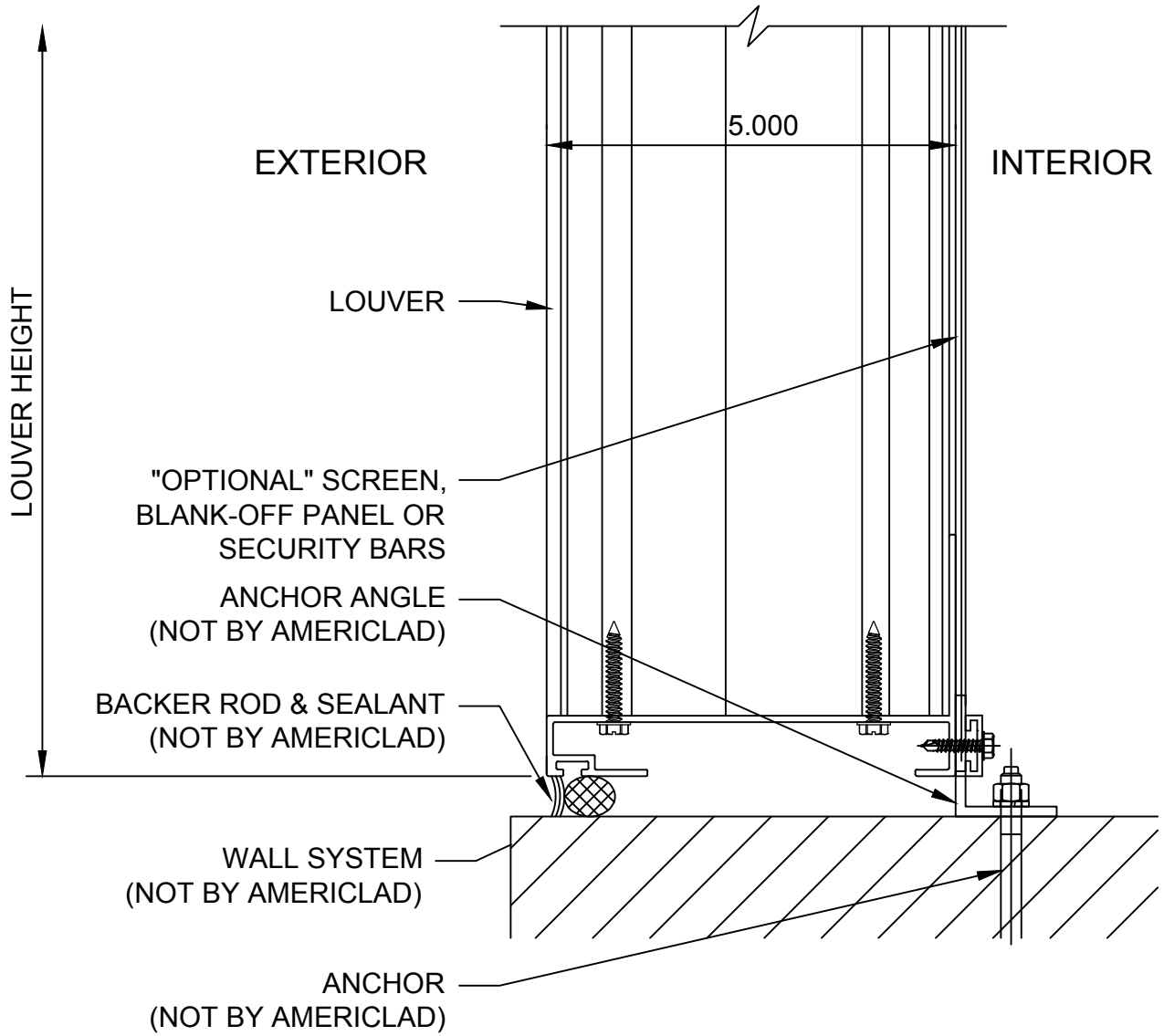

COPYRIGHT QUALITY METALCRAFTS, LLC

21925 Industrial Boulevard · Rogers, Minnesota · Toll-Free: 1-866-260-4047 · americlad.com

Architectural Metal Products



AC-95SCV

JAMB

DETAIL C

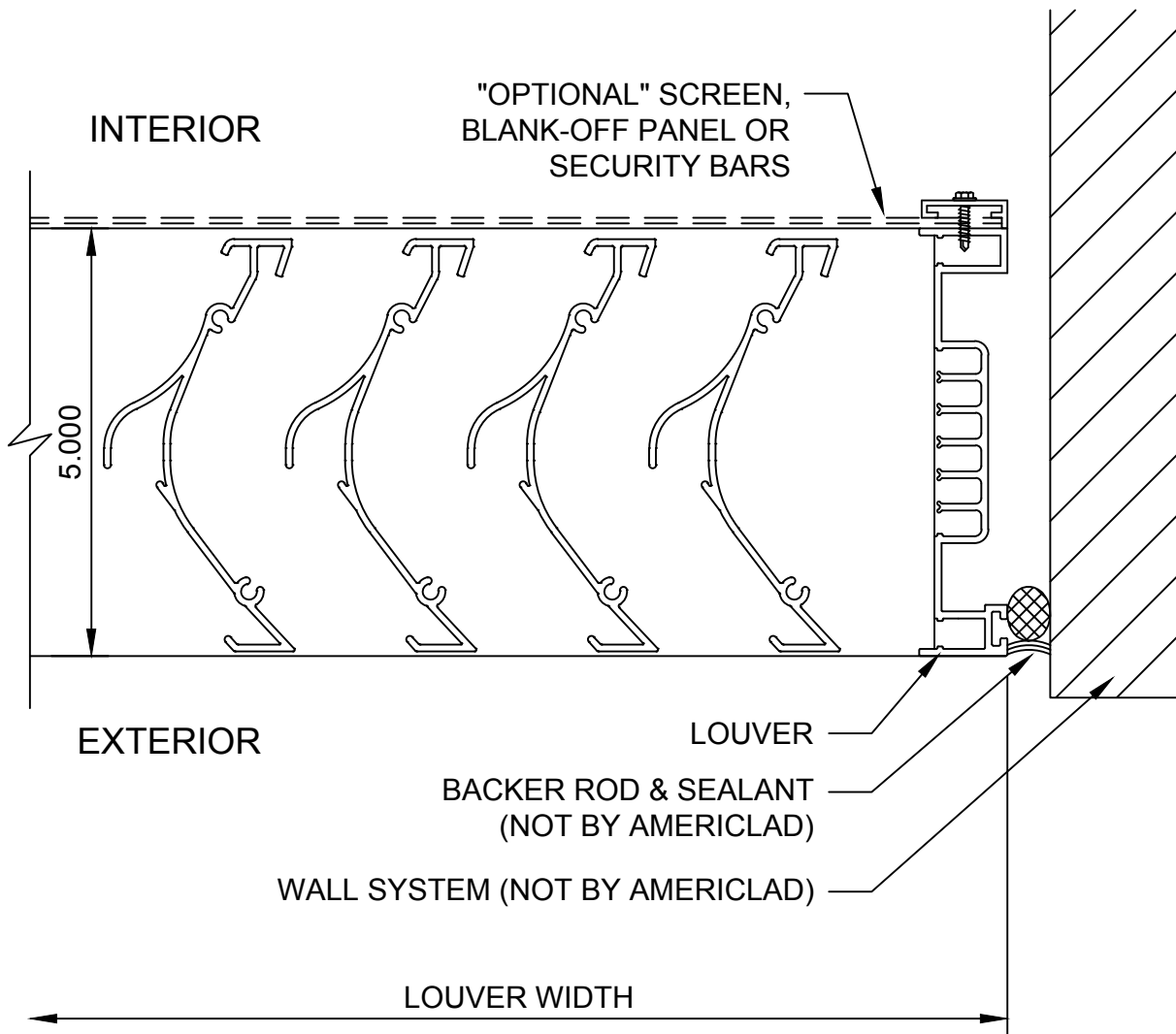

COPYRIGHT QUALITY METALCRAFTS, LLC

21925 Industrial Boulevard · Rogers, Minnesota · Toll-Free: 1-866-260-4047 · [americlad.com](http://americlad.com)  
Architectural Metal Products



AC-95SCV

HIDDEN MULLION

DETAIL D

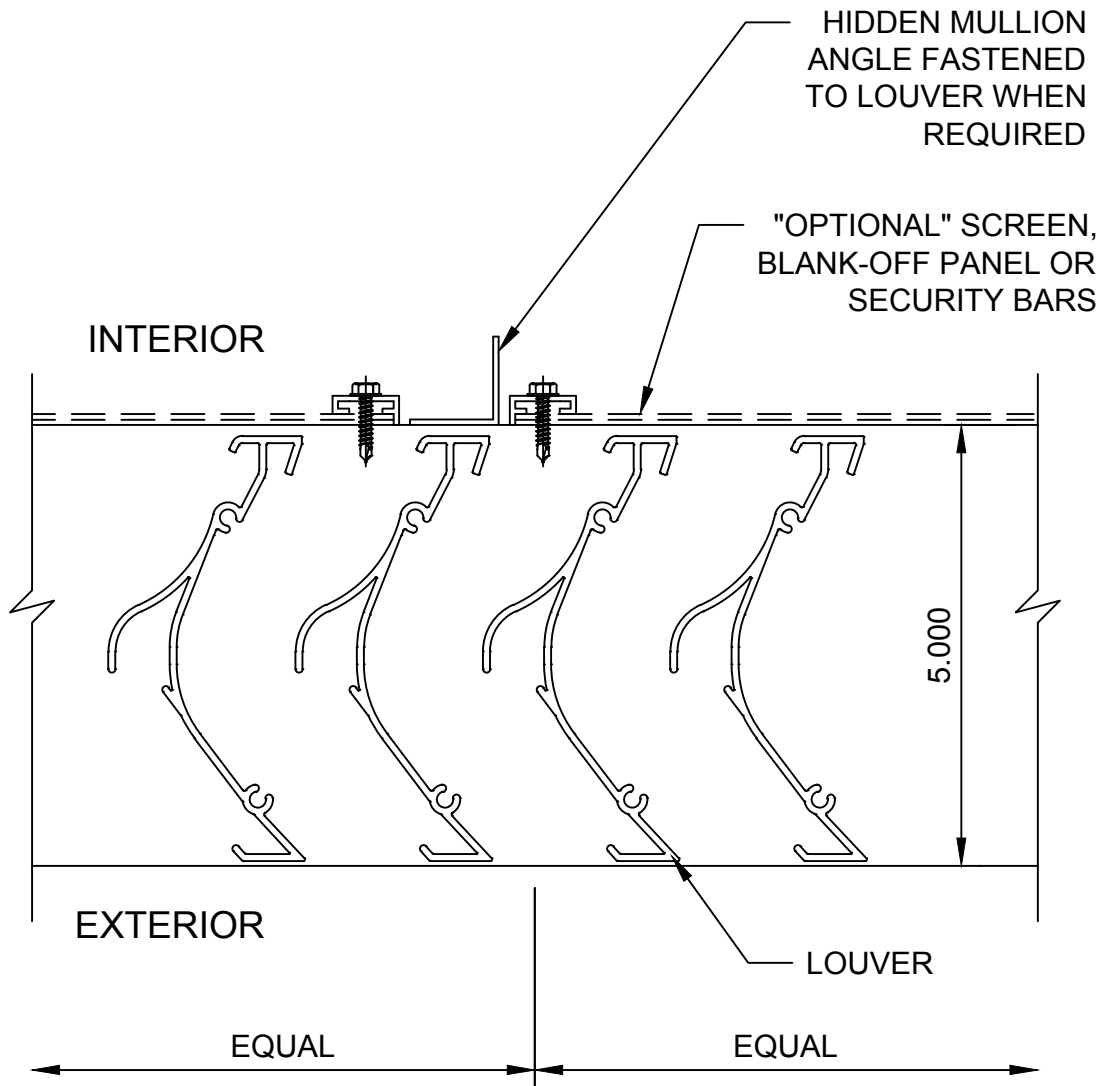

COPYRIGHT QUALITY METALCRAFTS, LLC

21925 Industrial Boulevard · Rogers, Minnesota · Toll-Free: 1-866-260-4047 · americlad.com

Architectural Metal Products



AC-95SCV

SPECIAL SHAPE LOUVERS

DETAIL E

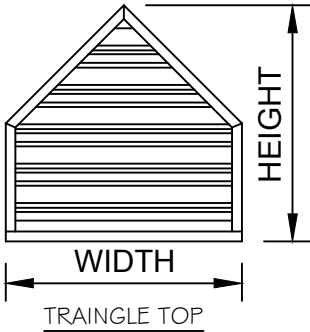
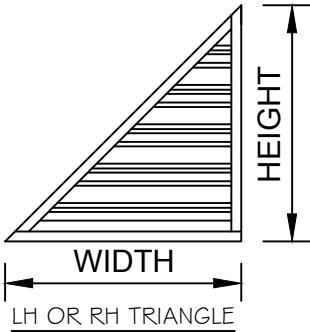
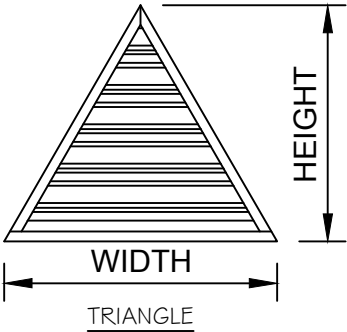
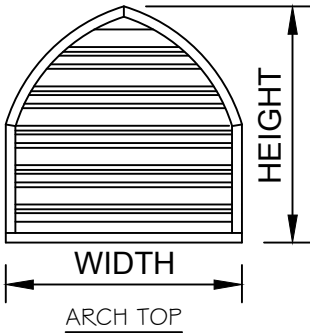
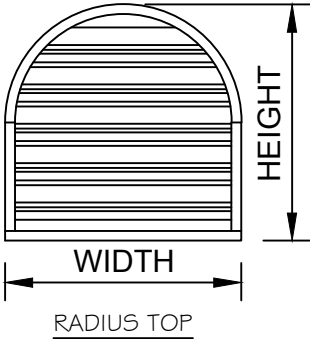
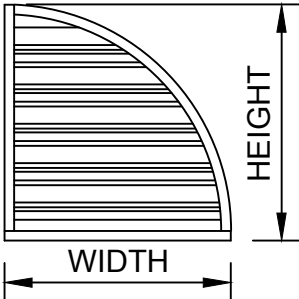
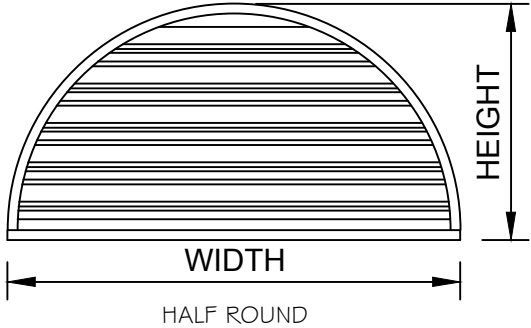
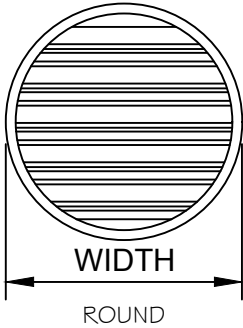

COPYRIGHT QUALITY METALCRAFTS, LLC